

Exhibit C
to Development Agreement
Disannexed Property

The 34.6 acres described in the attached metes and bounds description and depicted on the attached illustration.

FIELD NOTES
FOR A
DISANNEXATION TRACT
CITY OF NEW BRAUNFELS, TEXAS

Being 34.6 acres, more or less, out of the J.M. Veramendi Survey No. 2, Abstract 3, Comal County, Texas. Said 34.6 acres also being a portion of a 2086 acre tract of land described as First Tract in Deed recorded in Volume 167, Pages 80-92 of the Deed Records of Comal County, Texas. Said 34.6 acre tract being more fully described as follows;

BEGINNING: at a point on the northwest right-of-way line of State Highway Loop 337, being the south most corner of the called 17.089 acre tract of land conveyed to Oakwood Baptist Church of New Braunfels, Texas, by Deed Recorded in Document No. 200706020677, of the Official Records of Comal County, Texas;

THENCE: along the northwest right-of-way line of State Highway Loop 337, the following bearings and distances:

South 60°43'02" West a distance of 101.06 feet to a point,

South 54°19'02" West a distance of 391.10 feet to a point,

South 53°26'02" West a distance of 4077.20 feet to a point,

along a non-tangent curve to the left, said curve having a radial bearing of South 36°30'07" East, a radius of 2412.00 feet, a central angle of 10°41'17", a chord bearing and distance of South 48°09'15" West, 449.29 feet, for an arc length of 449.94 feet to a point on the south line of said 2086 acre tract and of the herein described tract;

THENCE: departing the northwest right-of-way line of State Highway Loop 337, along and with the south line of said 2086 acre tract, North 37°35'41" West a distance of 303.78 feet to a point of intersection with the New Braunfels City Limits line;

THENCE: departing the south line of said 2086 acre tract, over and across said 2086 acre tract, along and with the New Braunfels City Limits line, said City Limits line being parallel to and offset 300' from said northwest right-of-way line of State Highway Loop 337 the following bearings and distances:

along a non-tangent curve to the right, said curve having a radial bearing of South 46°07'13" East, a radius of 2712.00 feet, a central angle of 09°36'53" , a chord bearing and distance of North 48°41'14" East, 454.56 feet, for an arc length of 455.09 feet to a point,

North 53°26'02" East a distance of 4079.35 feet to a point,

North 54°19'02" East a distance of 410.19 feet to a point,

North 60°43'02" East a distance of 83.58 feet to a point on the southwest line of said called 17.089 acre tract,



THENCE: departing the New Braunfels City Limits line, along and with the southwest line of said called 17.089 acre tract, South 35°47'46" East a distance of 301.95 feet to the POINT OF BEGINNING, and containing 34.6 acres.

This document was prepared under 22 TAC 663.21, does not reflect the results of an on the ground survey, and is not to be used to convey or establish interests in real property except those rights and interests implied or established by the creation or reconfiguration of the boundary of the political subdivision for which it was prepared.

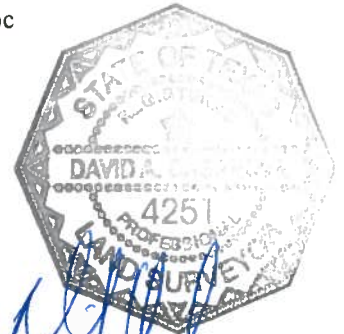
PREPARED BY: PAPE DAWSON ENGINEERS, INC.
DATE: March 23, 2012
JOB No.: 9127-10
FILE: N:\Survey10\10-9100\9127-10\WORD\34.6 Ac DEANNEX W MBs.doc



LEGEND

-  Project Boundary
-  New City Limits
-  Property to be Disannexed

THIS MAP REPRESENTS THE APPROXIMATE BOUNDARIES OF THE PROJECT COMPILED FROM DEED RECORDS AND LIMITED FIELD EVIDENCE. THIS DOES NOT REFLECT THE RESULTS OF AN ON THE GROUND SURVEY AND IT IS NOT TO BE USED TO CONVEY OR ESTABLISH INTERESTS IN REAL PROPERTY.

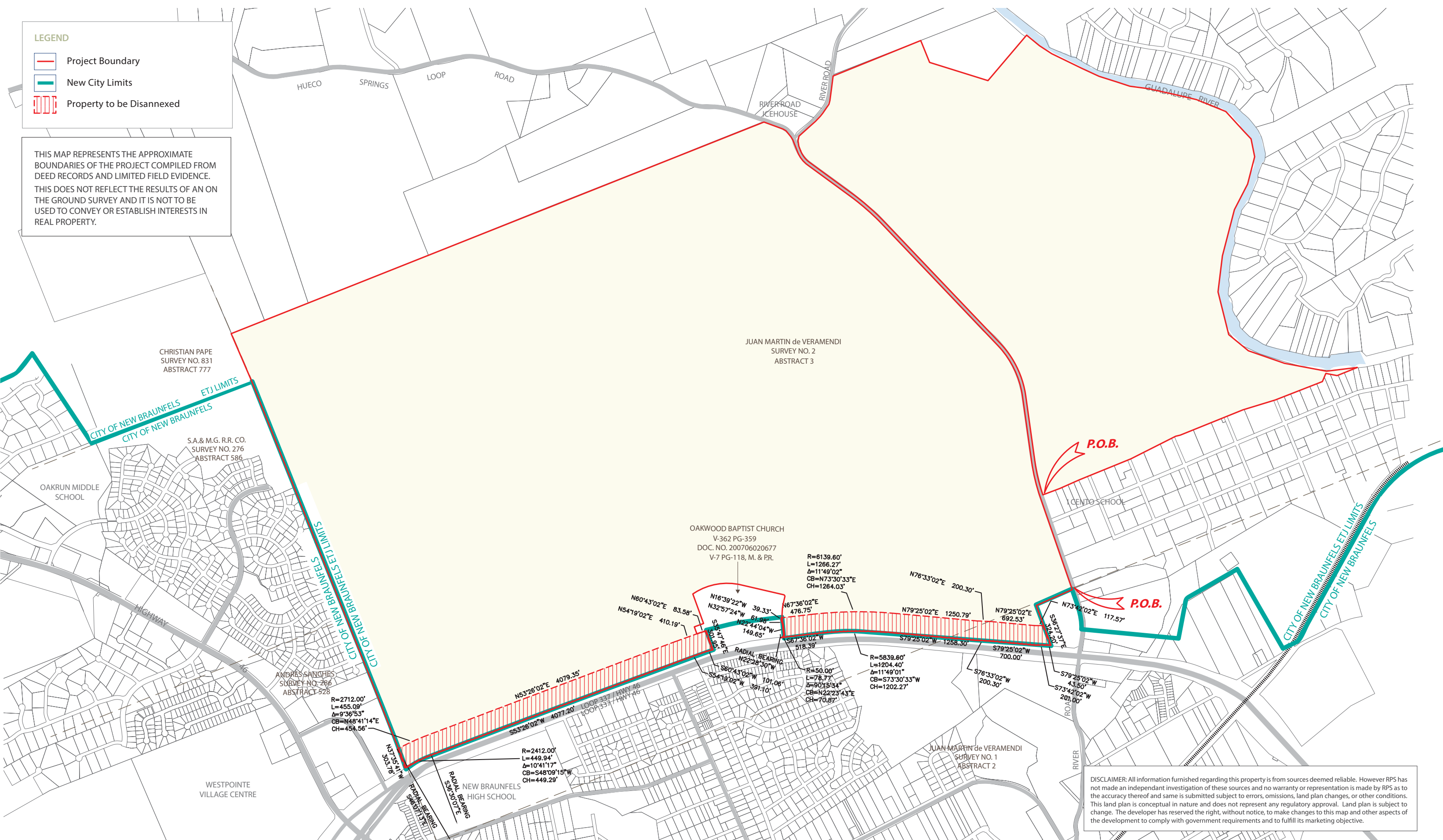

DISCLAIMER: All information furnished regarding this property is from sources deemed reliable. However RPS has not made an independent investigation of these sources and no warranty or representation is made by RPS as to the accuracy thereof and same is submitted subject to errors, omissions, land plan changes, or other conditions. This land plan is conceptual in nature and does not represent any regulatory approval. Land plan is subject to change. The developer has reserved the right, without notice, to make changes to this map and other aspects of the development to comply with government requirements and to fulfill its marketing objective.



Exhibit C
Disannexed Property