

## SMALL DUMPSTER CONTAINERS

### 3 YARD SLANT

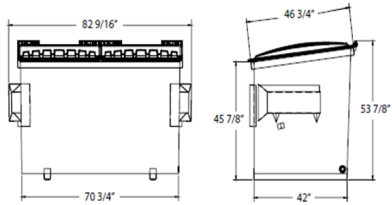

Approximately holds  
6-96gal carts

### 4 YARD SLANT

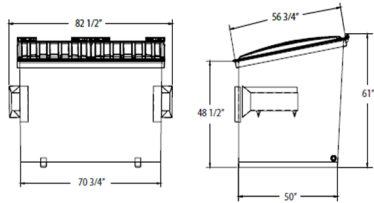

Approximately holds  
10-96gal carts

### 6 YARD SLANT

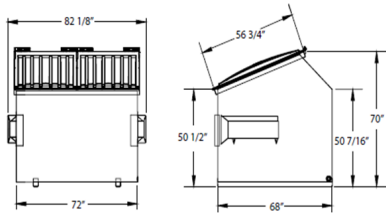

Approximately holds  
12-96gal carts

### 8 YARD SLANT

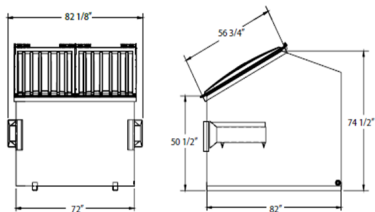

Approximately holds  
16-96gal carts

## ROLL-OFF CONTAINERS

### 20 Yard

### 30 Yard

### 40 Yard



We've got the right size container for every homeowner, property manager, or contractor's needs.  
Call us to discuss your next project.



# DUMPSTER & ROLL-OFF CONTAINER RENTALS



424 S Castell Avenue  
New Braunfels TX 78130

Office: 830.221.4040

Email: [sanitation@nbtexas.org](mailto:sanitation@nbtexas.org)  
Website: [www.nbtexas.org/swrd](http://www.nbtexas.org/swrd)

830.221.4040  
[www.nbtexas.org/swrd](http://www.nbtexas.org/swrd)

## RATES

Type of Container	Rental + Delivery Fee**	Service Fee**
3 cubic yards	\$45/month	\$15
4 cubic yards	\$45/month	\$20
6 cubic yards	\$45/month	\$30
8 cubic yards	\$45/month	\$40
20, 30, 40cy Roll-off	\$150/month + \$150 delivery	\$150 + cost of disposal

\*\* Minimum one month rental fee, delivery fee, and one service fee due prior to delivery of container. All rentals are subject to sales tax.

## WE ACCEPT:

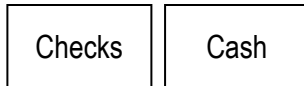

## CONTAINER RENTALS TERMS AND CONDITIONS:

**PLACEMENT GUIDELINES:** Rental containers cannot be placed in locations where there are overhead obstructions such as wires and tree limbs. The collection truck must have a straight approach to empty the container. Rental containers will NOT be emptied if vehicles are parked within four (4) feet of the container. **THE CITY IS NOT LIABLE FOR DAMAGES DONE TO ITEMS THAT ARE STORED ON OR AROUND THE CONTAINER. PLEASE NOTE: YOU MUST INITIAL THE LIABILITY WAIVER BEFORE WE WILL PLACE A CONTAINER ON AND/OR DRIVE OUR VEHICLES ON YOUR LAWN OR ASPHALT/CONCRETE DRIVEWAY. CONTAINERS WILL ONLY BE PLACED ON CONCRETE, ASPHALT, OR BASE MATERIAL, WE WILL NOT PLACE IN GRASS, BEHIND FENCES OR GATES.**

**DO NOT PLACE REFRIGERATORS, AIR CONDITIONING UNITS, ITEMS CONTAINING A REFRIGERANT (SUCH AS FREON), OR TIRES IN CONTAINERS. THESE ITEMS REQUIRE SPECIAL HANDLING.**

**DO NOT DISPOSE OF THE FOLLOWING ITEMS IN THE CONTAINER:** Toxic/hazardous wastes such as paint, oil, batteries, chemicals, TVs, computer monitors, computer parts, insecticides, herbicides, pesticides, cleaning supplies, propane tanks, asbestos, tires, or appliances containing refrigerant. These items are designated as hazardous waste and have special handling requirements. **Any unauthorized waste will be removed by customer prior to service, unauthorized waste detected while dumping shall be returned to the customer for proper disposal.**



**ALL RENTAL CONTAINERS ARE EMPTIED AND/OR REMOVED ON A NEXT BUSINESS DAY BASIS UNLESS OTHERWISE NOTED.** The customer must call during business hours to schedule an empty or removal of a container. Business hours are Monday through Friday, 8:00 am to 5:00 pm and closed for major holidays. A \$25 fee will be charged for returns when containers are blocked and will be rescheduled for the next available day.

**DO NOT OVERFILL THE CONTAINER.** A container is considered full when the waste materials are level with the top lip of the container and the lids will fully close. Overfilled containers cause spillage and pose a hazard to drivers and collection equipment. Garbage found on the ground will not be collected. All excess material must be removed by the customer before the container will be emptied. A \$25 fee will be charged for returns when containers are overfull and will be rescheduled for the next available day.

**DO NOT MOVE THE CONTAINERS.** SWRD will place the container according to the provided placement instructions; however, once the container is placed do not move it. Moving the container without proper equipment may cause damage or make it inaccessible for the collection vehicle to safely remove it. You can arrange for alternate container placement when you call for an empty as long as the container remains at the same address/location.

**CONCRETE, DIRT, ROCKS, BRICKS, ROOF GRAVEL, AND GREEN WASTE ARE NOT ACCEPTABLE IN CONTAINERS.** These items are extremely heavy and can damage our collection equipment. If you need to dispose of concrete, dirt, rocks, bricks, and/or roof gravel, self haul to the landfill, take green waste to Comal County Recycle Center.